

# 41375 Standing Waste • Spec Sheet

## FEATURES & BENEFITS

- 1-1/2" Male
- Brass

## ALSO AVAILBLE:

- 41380 - 1-1/2" Female
- 41390 - 1-1/2" Male / Female Combo

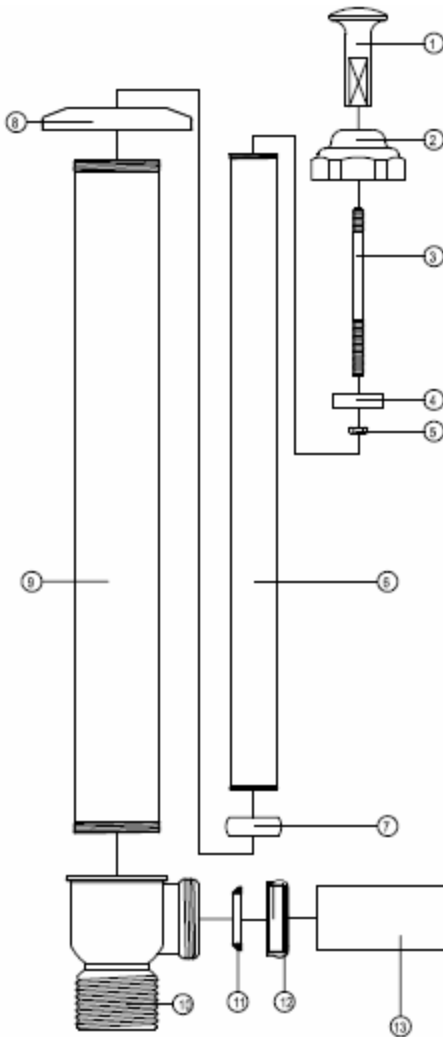

NO	PARTS	MATERIALS
1	HANDLE	BRASS B124 C37700
2	BONNET	BRASS B124 C37700
3	STEM	BRASS B124 C37700
4	CAP	BRASS B124 C37700
5	NUT	BRASS B124 C37700
6	STEM PIPE	BRASS C27000
7	SEAT	BRASS B124 C37700
8	FLANGE	STAINLESS STEEL
9	HANDLE PIPE	BRASS C27000
10	BODY 1	BRASS B584 C85710
11	PACKING	POM - M90 POLYACETAL
12	PACKING NUT	BRASS B584 C85710
13	DRAIN PIPE	BRASS C27000
14	BODY 2	BRASS B584 C85710
15	PACKING	RUBBER SAE NO 1052#
16	PACKING	FIBRE
17	FILTER	BRASS B584 C85710
18	FILTER CAP	STAINLESS STEEL
19	BOLT	BRASS B124 C37700

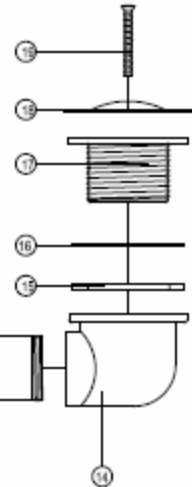

**MATCO-NORCA**  
Global sourcing. National compliance. Local service.

**NEW YORK** PO Box 27, Rt. 22, Brewster NY 10509 • Toll Free: 800-431-2082 • Fax: 845-278-9056  
**TEXAS** 1150 Silber Rd., Houston TX 77055 • Toll Free: 800-935-5456 • Fax: 713-680-2999  
**CALIFORNIA** 5593 Fresca Dr., La Palma CA 90623 • Toll Free: 866-532-8306 • Fax: 866-532-8307  
 WEB: [www.matco-norca.com](http://www.matco-norca.com) EMAIL: [mail@matco-norca.com](mailto:mail@matco-norca.com)